

Adaptor Push-Pull Type 4.3-10 Plug to 4.3-10 Socket || BN 432051

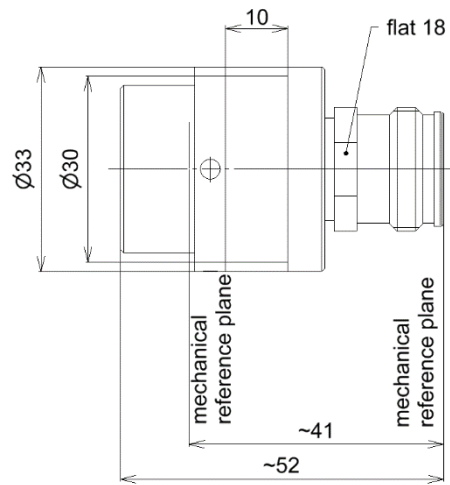

all dimensions in millimeter

Interface type	4.3-10 (50 Ω) per IEC 61169-54	
Frequency range	DC to 2.7 GHz	
VSWR, max.	1.08 @ DC to 2.7 GHz	
Intermodulation (IM3) 2x20 W max.	-163 dBc	
Insertion loss max.	0.3 dB	
Misalignment corrections		
Matings	500 <sup>1)</sup>	
Inner conductor material / surface finish	DUT interface	Rear interface
	CuBe age-hardened / gold-plated	CuBe / silver-plated
Outer conductor material / surface finish	DUT interface	Rear interface
	copper alloy / gold-plated	copper alloy / silver-plated
Other metal parts / surface finish	copper alloy / nickel-plated aluminum / nickel-plated CuBe stainless steel	
Insulation	LCP	
Latching	manual-locking	
Weight, approx.	110 g	
Ambient temperature range	+5 °C to +40 °C (indoor)	

1) In order to ensure best possible measurement result, cleaning has to be assessed and executed by professional staff on a regular basis.